



Wright Marshall

Estate Agents

12 Church Row Bunbury CW6 9PL



£275,000

1 Princess Street, Knutsford, Cheshire, WA16 6BY
T. 01565 621624
Knutsford@wrightmarshall.co.uk /
Cheshirelettings@wrightmarshall.co.uk



THREE BEDROOM PROPERTY, IN NEED OF UPDATING, QUIET CUL DE SAC LOCATION, OPEN VIEWS TO THE REAR, SHORT WALK FROM BUNBURY VILLAGE, NO ONWARD CHAIN

Set on a generous corner plot within a quiet cul-de-sac, just a short walk from the picturesque village of Bunbury, this three-bedroom end mews home offers excellent potential and has been in the same family for many years.

By the vendor's own admission, the property is in need of general refurbishment throughout and should be viewed as a project opportunity.

Arranged over two floors, the accommodation briefly comprises a covered porch opening into an entrance hallway with stairs to the first floor, a spacious dual-aspect lounge with feature fireplace, and a fitted kitchen with an Aga-style stove. To the rear, the property benefits from additional space via outhouses that have been connected to the main house by a previous owner, offering scope for further development or conversion (subject to planning).

The first floor features three well-proportioned bedrooms, all served by a three-piece family bathroom.

Externally, a paved pathway leads to the front door with a lawned garden to the front, while to the rear there is a split-level garden with lawns to both the side and stepped-down rear sections, enjoying open views across the surrounding countryside.

This charming home is offered to the

market with no onward chain, presenting an ideal opportunity for those seeking a project in one of Cheshire's most sought-after village locations.





GROUND FLOOR
512 sq.ft. (47.5 sq.m.) approx.

1ST FLOOR
435 sq.ft. (40.4 sq.m.) approx.

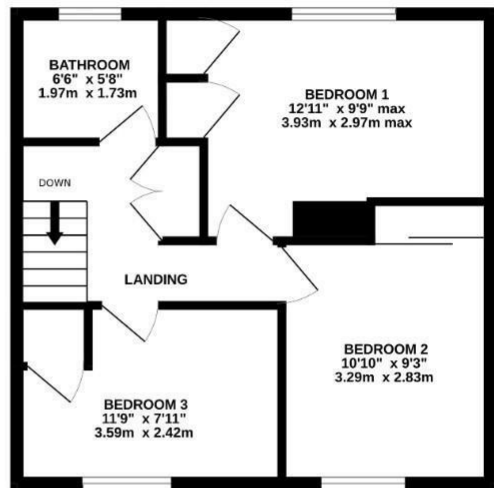
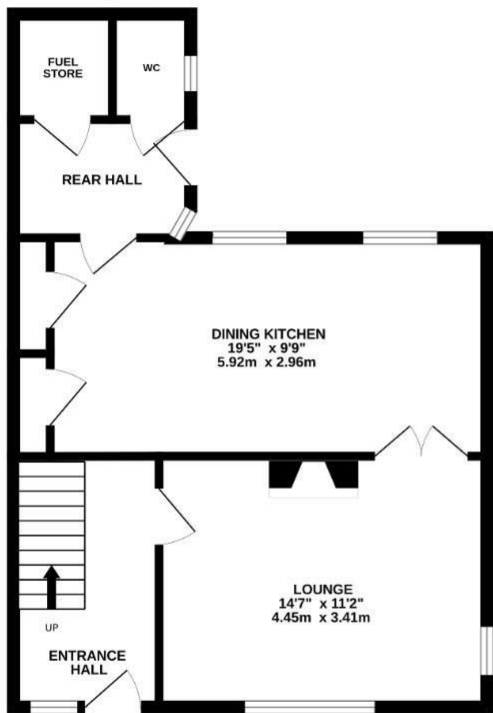

TOTAL FLOOR AREA : 947 sq.ft. (87.9 sq.m.) approx.

Whilst every attempt has been made to ensure the accuracy of the floorplan contained here, measurements of doors, windows, rooms and any other items are approximate and no responsibility is taken for any error, omission or mis-statement. This plan is for illustrative purposes only and should be used as such by any prospective purchaser. The services, systems and appliances shown have not been tested and no guarantee as to their operability or efficiency can be given.
Made with Metropix ©2025

These particulars, whilst believed to be accurate are set out as a general outline only for guidance and do not constitute any part of an offer or contract. Intending purchasers should not rely on them as statements of representation of fact, but must satisfy themselves by inspection or otherwise as to their accuracy. No person in this firm's employment has the authority to make or give any representation or warranty in respect of the property.